

# Leaf - recycling schemes

## Jenner Wing 2<sup>nd</sup> floor

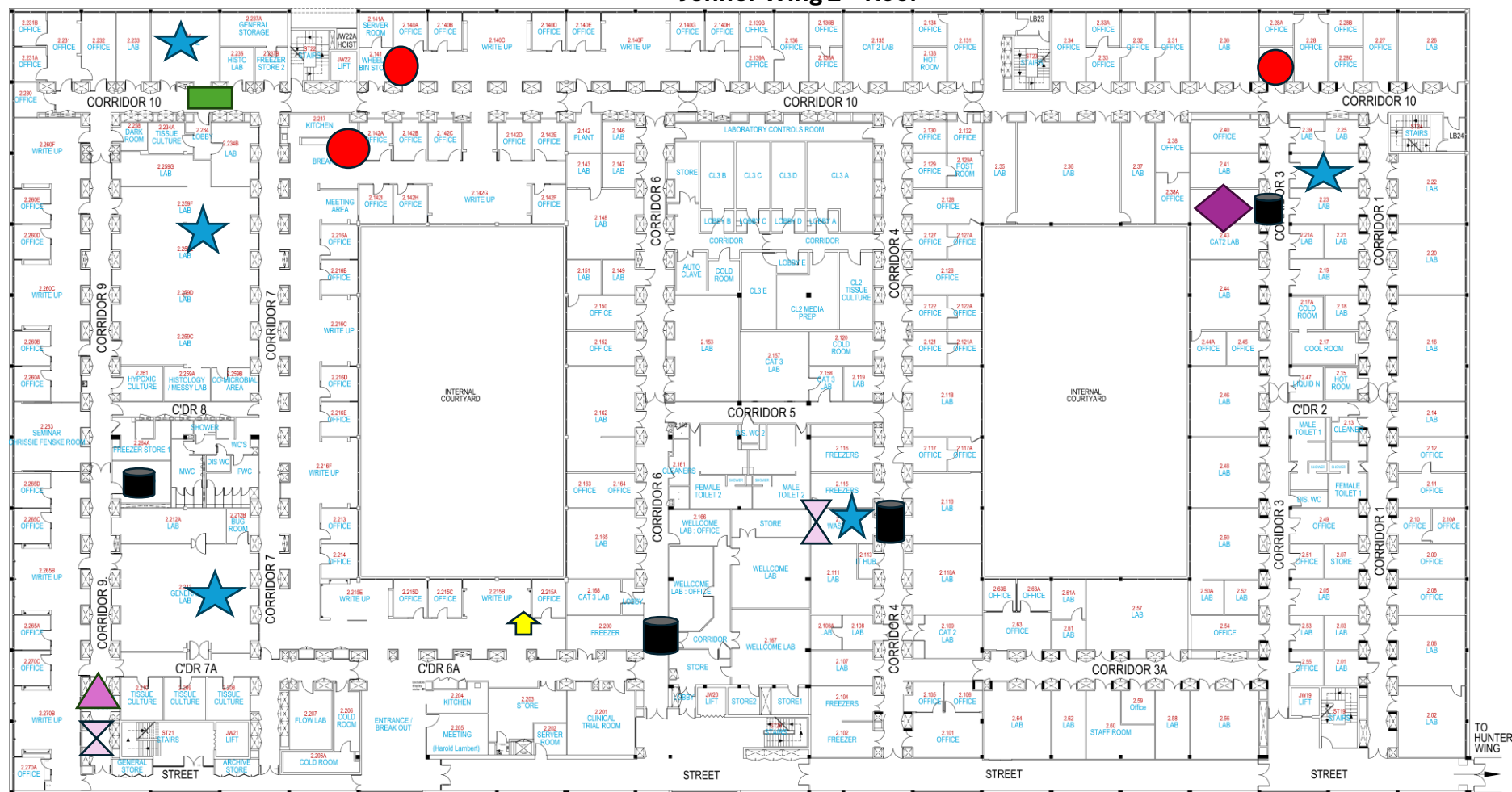

- ★ Star Lab
- ▲ VWR
- Royal Mail
- ◆ Polystyrene boxes & ice packs
- Recycling caddy
- ↑ Battery Recycling
- ✕ Lab Coats
- Glass Bin

## Leaf -recycling schemes

## Jenner Wing 1st floor



## Scheme

## Locations



StarLab

1<sup>st</sup> floor - 1.124(Corridor 4)

2<sup>nd</sup> floor - 2.235(Corridor 10)

2.259(Corridor 7/9)

2.212(Corridor 7/9)

2.114(Corridor 4)

2.024(Corridor 1/3)

2<sup>nd</sup> floor - 2.211(Corridor 7A/9)



VWR



Lab Coat

2<sup>nd</sup> floor - 2.114(Corridor 4)

2.211(Corridor 7A/9)



Polystyrene boxes  
& ice packs

2<sup>nd</sup> floor – 2.024(Corridor 3)



BioLabs NEB/  
Royal Mail

1<sup>st</sup> floor – Corridor 4/10

PHRI (Corridor 10)

1.245 (Corridor 10)

2<sup>nd</sup> floor – Break Out Area

2.140C Area

Room 2.29 (Corridor 10)



Recycling caddy

1<sup>st</sup> floor – Corridor (Street/Corridor 6)

2<sup>nd</sup> floor – Corridor 10



Glass recycles bin

1<sup>st</sup> floor – Corridor 4- 1.124

2<sup>nd</sup> floor – Corridor 6

2.264b , 2.114, 2.042

